

Nominal pressure 1 & 2.5

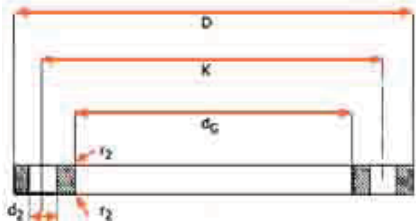

Nominal width	Nominal pressure 1 and 2.5 Bolts					
	D	dg	k	Quantity	Thread	d2
6	Mating dimensions , See under nominal pressure 6					
8						
10						
15						
20						
25						
32						
40						
50						
65						
80						
100						
125						
150						
(175)						
200						
250						
300						
350						
400						
(450)						
500						
600						
700						
800						
900	1375	1280	1320	302	M27	30
1000						
1200						
1400	1575	1480	1520	36	M27	30
1600	1790	1690	1730	40	M27	30
1800	1990	1890	1930	44	M27	30
2000	2190	2090	2130	48	M27	30
2200	2405	2295	2340	52	M30	33
2400	2605	2495	2540	56	M30	33
2600	2805	2695	2740	60	M30	33
2800	3030	2910	2960	64	M33	36
3000	3230	3110	3160	68	M33	36
3200	3430	3310	3360	72	M33	36
3400	3630	3510	3560	76	M33	36
3600	3840	3720	3770	80	M33	36
3800	4045	3920	3970	80	M36	39
4000	4245	4120	4170	84	M36	39
DN= Nominal size of metal ring				D= Outside diameter of metal ring		
D1= Outside diameter of PE pipe				d6= Inside diameter of metal ring		

Office Address:

No.8 (Suit 6), Nour Alley, Africa St., Tehran/IRAN.....

Tel.: (+98 21) 88 67 79 65 , 88 67 79 66, 88 67 39 19 , 88 67 39 18 - Fax: (+98 21) 88 87 85 81

www.parsethylene-kish.com